

## GROUP 51

### EXTERIOR

#### GENERAL

#### OUTLINE OF CHANGES

- The service procedure for the front bumper has been added to correspond to the use of the licence plate bracket.  
Applicable models: 1900D
- The following procedure has been added to correspond to the addition of the 4-door sedan.  
Applicable models: 4-door sedan
  1. Removal and installation of the drip moulding
  2. Removal and installation of the marks
- The following procedure has been added to correspond to the use of the rear spoiler.  
Applicable models: 4-door sedan <1800-DOHC>
- The grade marks have been added to correspond to the addition of the diesel-powered vehicle.  
Applicable models: 4-door hatchback <1900D>

#### FRONT BUMPER

#### DISASSEMBLY AND REASSEMBLY

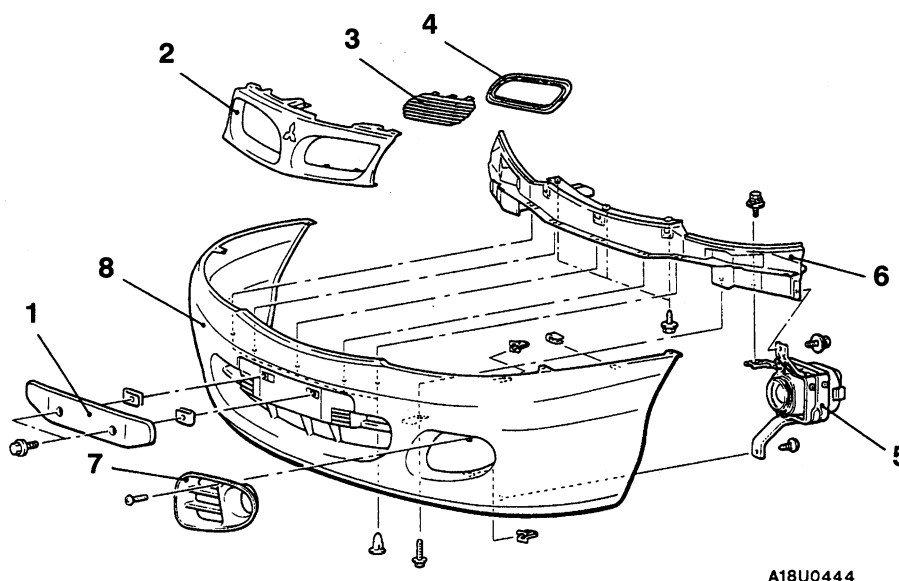

A18U0444

#### Disassembly steps

1. Licence plate bracket
2. Radiator grille, outer
3. Radiator grille, inner
4. Radiator grille cover
5. Front fog lamp
6. Bumper reinforcement

7. Fog lamp cover
8. Bumper face

#### NOTE

For removal and installation of the bumper assembly, refer to the basic manual.

## MOULDINGS

### REMOVAL AND INSTALLATION

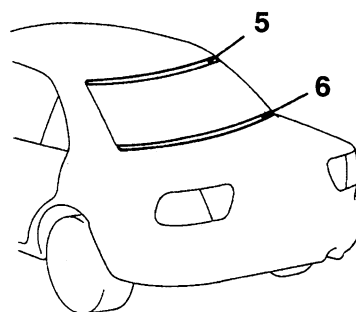
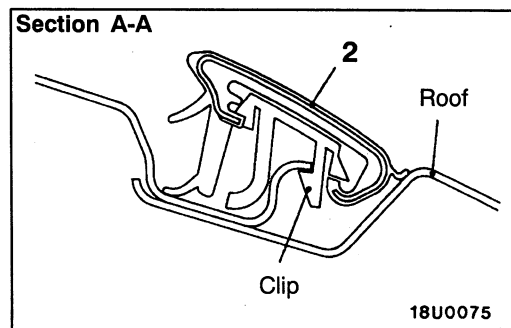
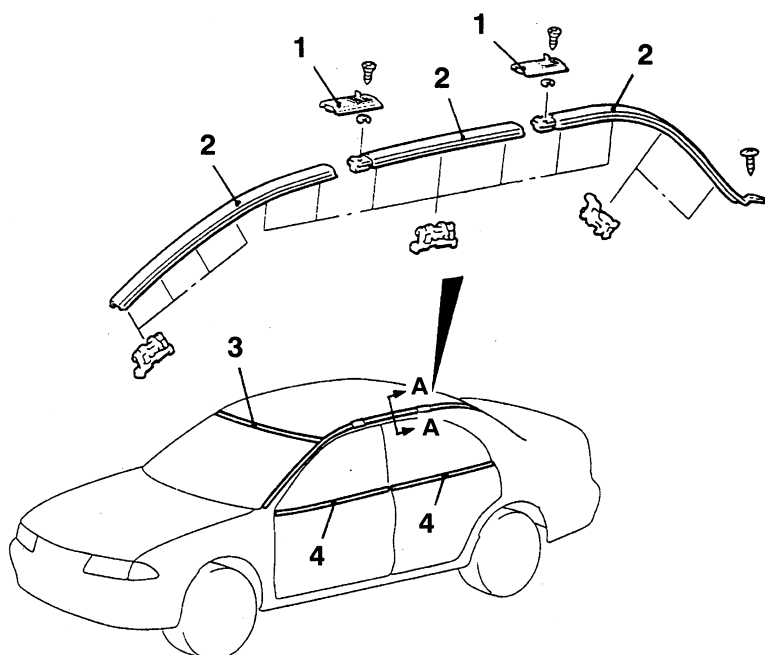

18U0446  
00005102

- ◀A▶ ▶A▶
1. Roof carrier caps
  2. Roof drip moulding
  3. Windshield upper moulding
  4. Belt line moulding
  5. Rear window upper moulding  
(Refer to GROUP 42 - Window Glass.)

6. Rear window lower moulding  
(Refer to GROUP 42 - Window Glass.)

**NOTE**  
For service point, refer to Basic Manual.

## AERO PARTS

### REMOVAL AND INSTALLATION

<Rear spoiler>

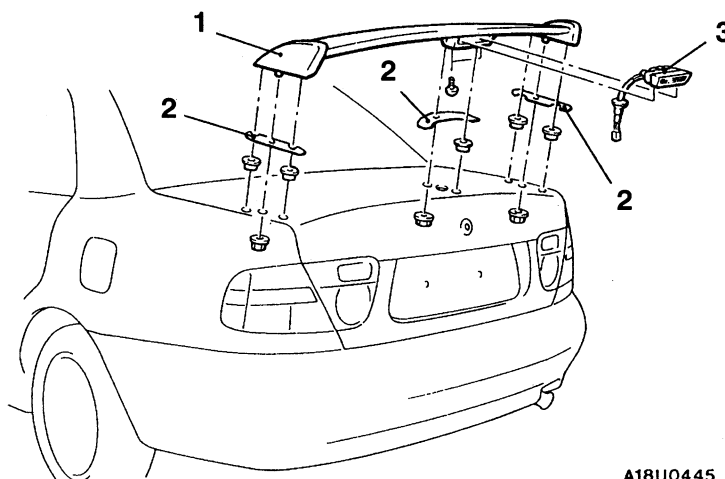

A18U0445

#### Removal steps

1. Rear spoiler
2. Packing

3. High mounted stop lamp assembly

## MARKS

## REMOVAL AND INSTALLATION

## HATCHBACK

Unit: mm

## GRADE MARK

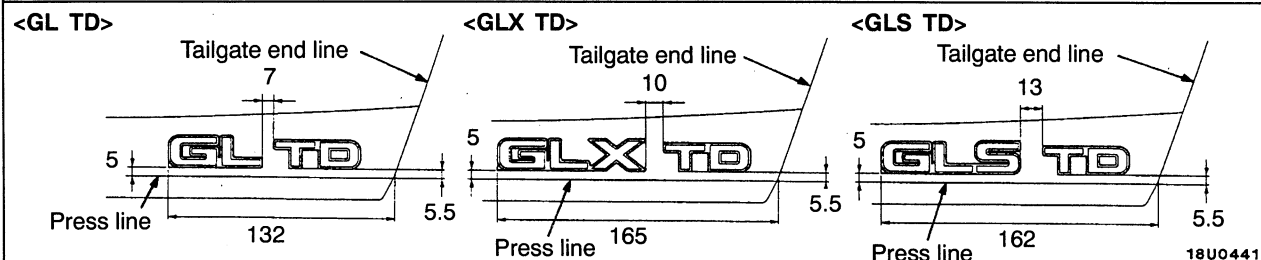

## SEDAN

## CARISMA MARK

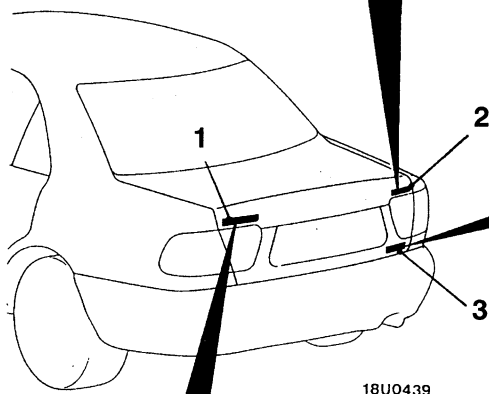
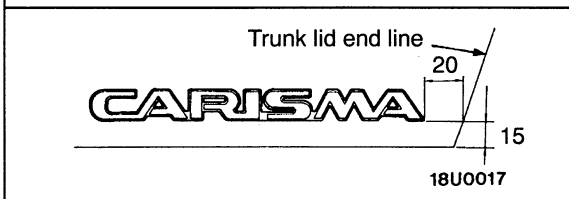

## MITSUBISHI MARK

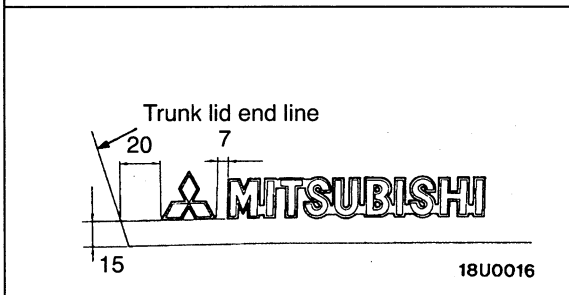

## GRADE MARK

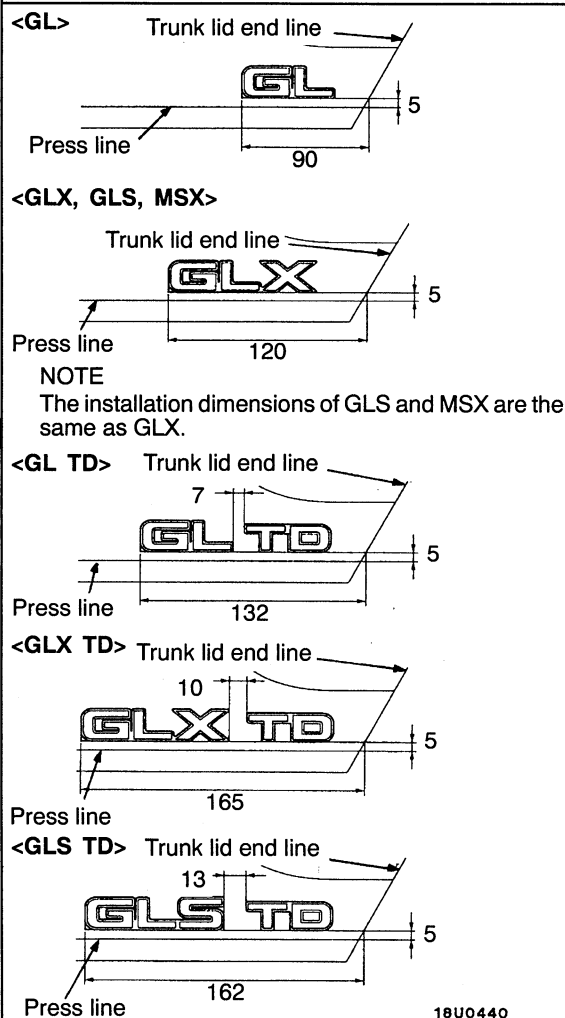

1. MITSUBISHI MARK
2. CARISMA MARK
3. GRADE MARK